

Technical sheet: 77623 STAINLESS STEEL BUILT-IN NICHE 304

Installation Instructions

1. Make sure the wall is smooth and level.
2. Drill a hole in the wall according to the niche dimensions: 585 × 285 × 68 mm. The hole must allow a maximum positive tolerance of 2 mm.
3. Insert the niche into the hole and press firmly.
4. Apply acrylic or silicone sealant along the edges to prevent water ingress.
5. Wait until the sealant is completely dry before use.

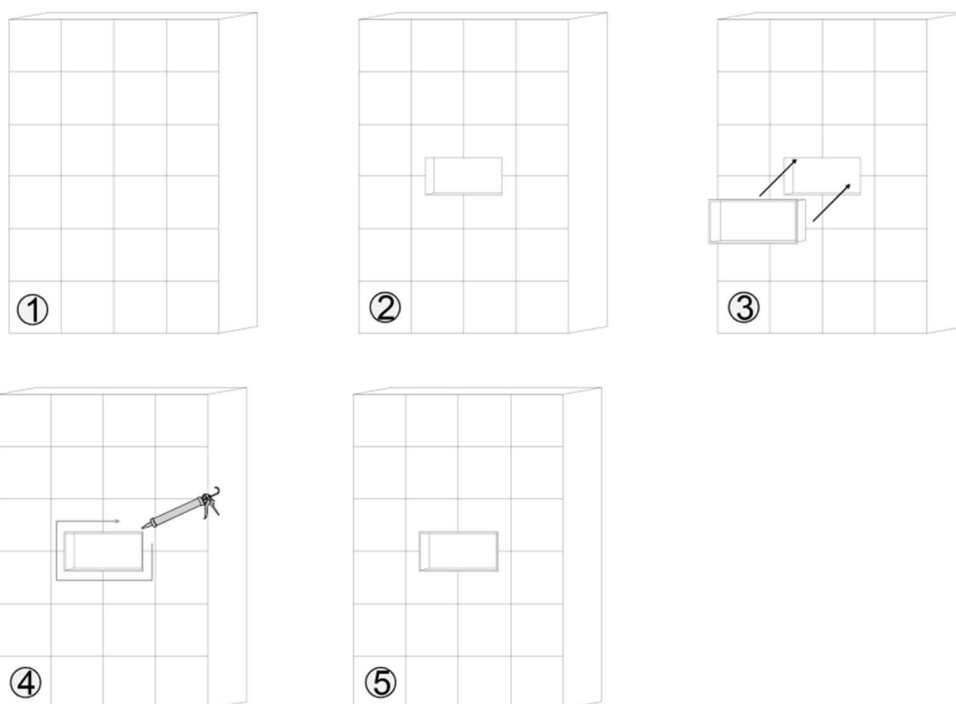

Maintenance Instructions

- Avoid water accumulation inside the niche, as it can cause limescale or rust. Always dry with a sponge or soft cloth.
- Clean with water or mild detergent, then dry. Do not use acidic or alkaline cleaning agents.
- Do not use sharp or abrasive objects, which may damage the surface.