

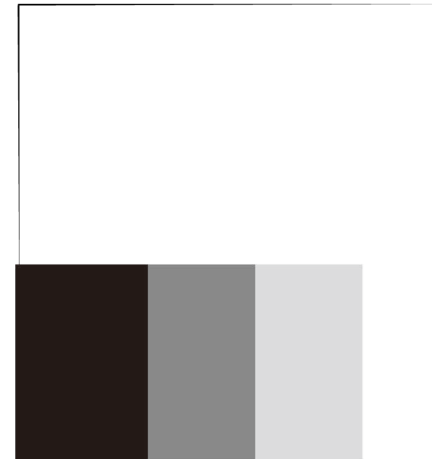



FANTASY2 FRONT DOOR INSTRUCTION





Notice and Maintenance

- 1)Clean the sliding track and adjust rollers regularly;
- 2)CLEANING- use only warm soapy water and damp cloth/sponge on a regular basis;
Do not use abrasive scouring powders, chemicals or aerosol cleaners- these may result in damage to the surfaces, in particular, the plated component parts;
- 3)Do not put your hands between glass doors when sliding;
- 4)Do not climb shower enclosure
- 5)Do not hang heavy articles on shower enclosure



We appreciate your choosing of our shower products, and wish you a pleasant experience with our products and service. Please read Instruction carefully before installation.



Catalogue

- | | |
|---|----|
| 1) Check Appearance of Shower Enclosure | 1 |
| 2) Picture of Parts | 2 |
| 3) Scheme of Installation | 3 |
| 4) Notice and Maintenance | 10 |

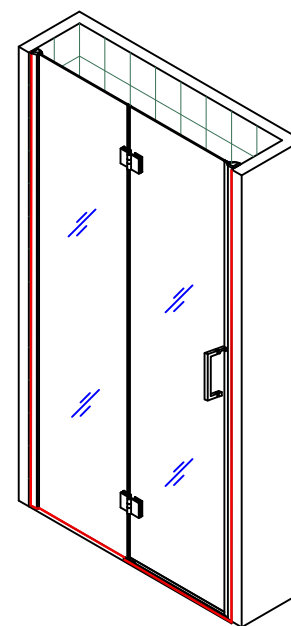

L

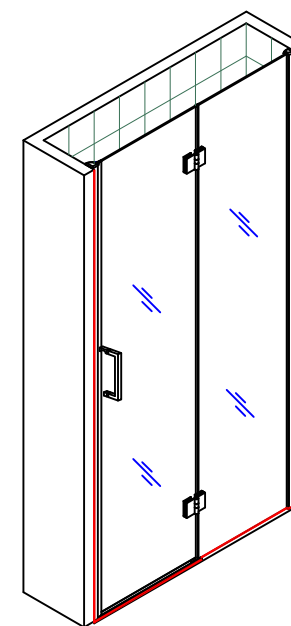

R

Shower Door fantasy 2 is reversible and can be assembled in both Left and Right sides, the following assemble chart just shows the installation of Left version.

Shower door Fantasy2 can be installed in the niche with magnet profile (need buy separately), also, it can combine with a Fixed side panel into a shower enclosure, and in that case, the magnet profile is not needed.

19

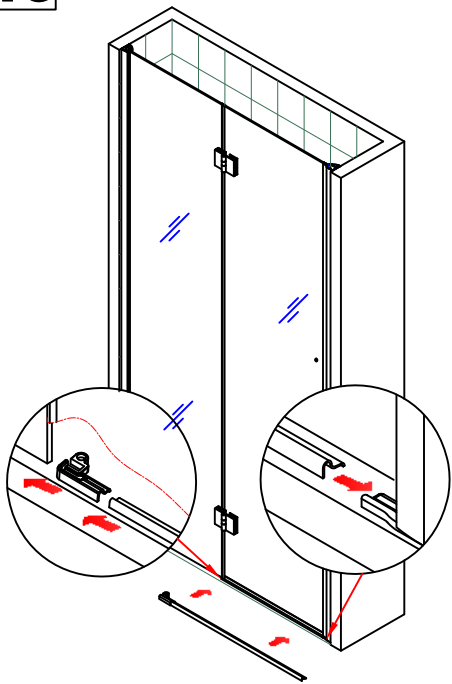

20

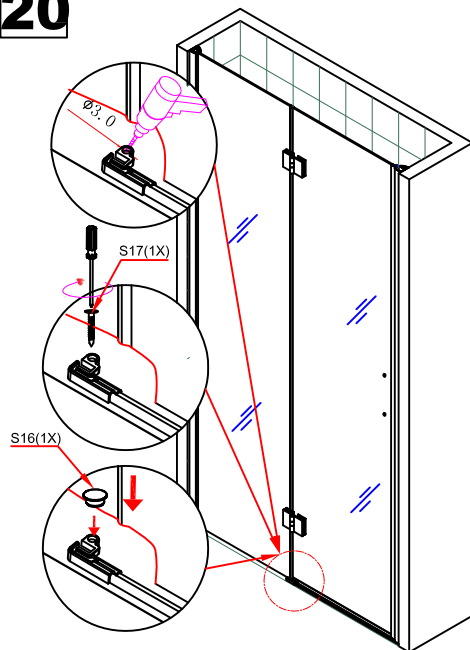

21

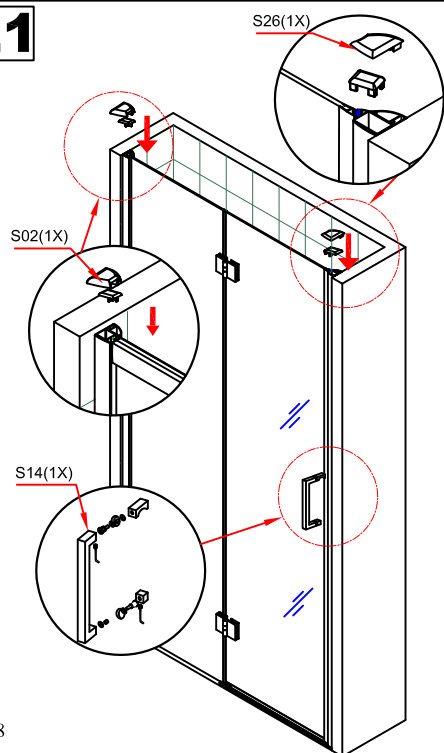

22

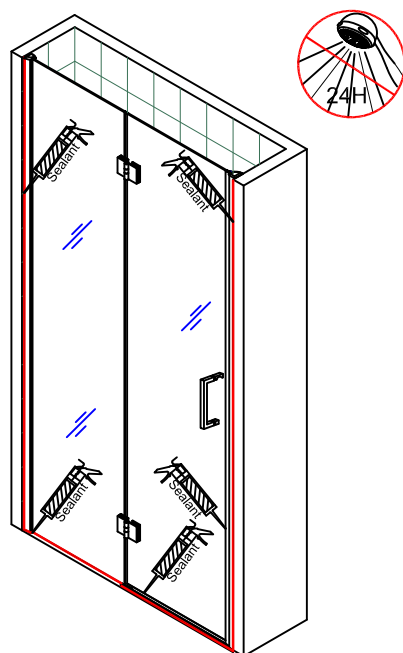

Check Appearance of Shower Enclosure

1) Any defects must be reported to seller before assembly / installation.

2) Claims for imperfections will only be accepted prior to assembly / installation.



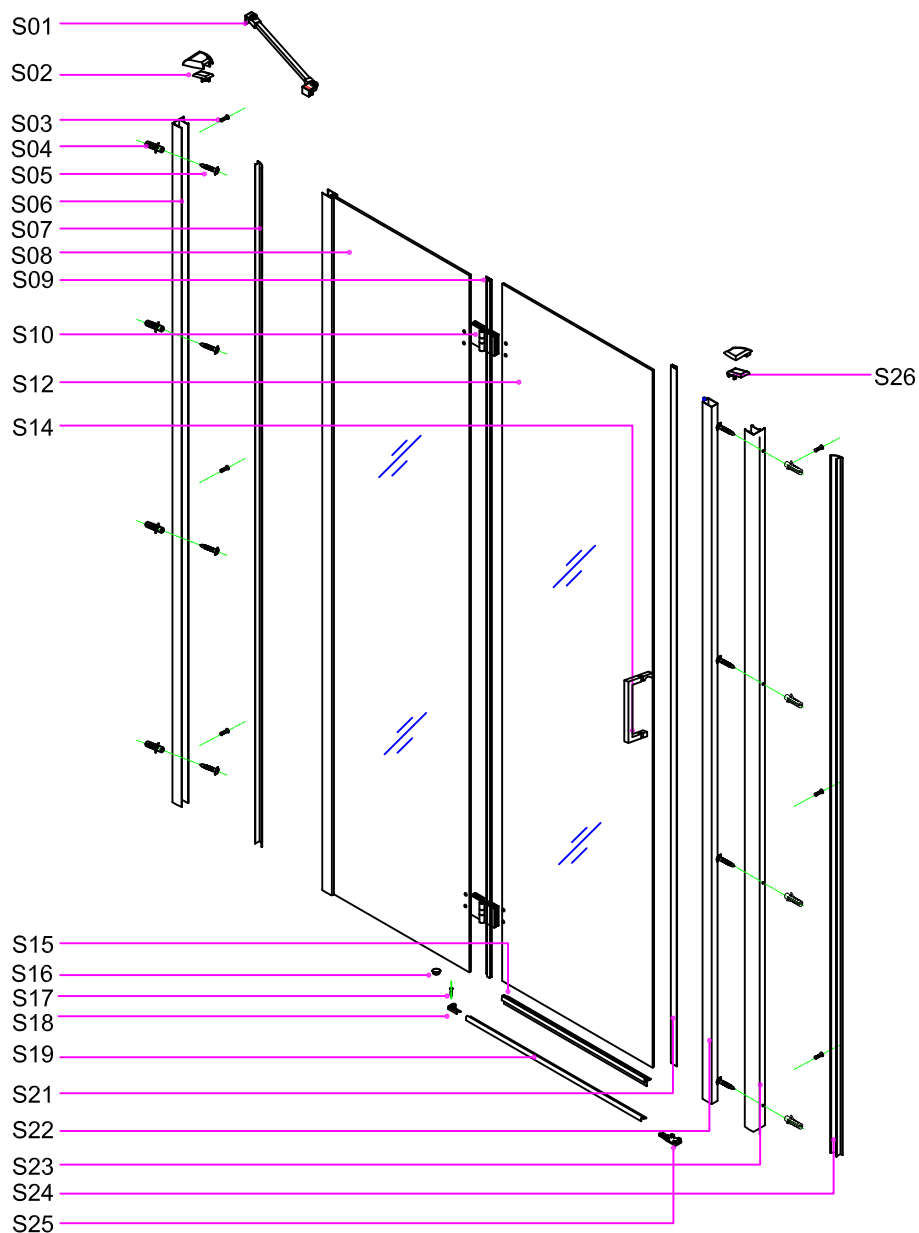

Magnet profile parts (S21 – 26) are not included in the package of FANTASY2 FRONT DOOR. Those parts must be bought separately when the FANTASY2 FRONT DOOR is to be mounted in niche.

15

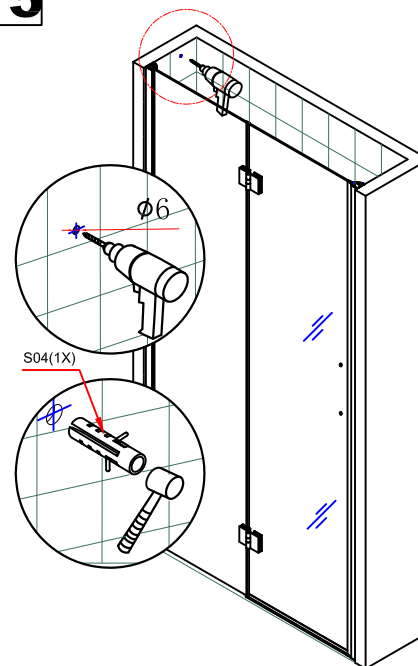

16

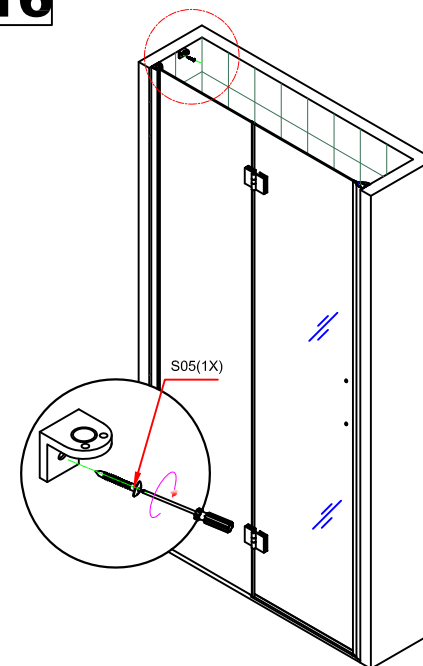

17

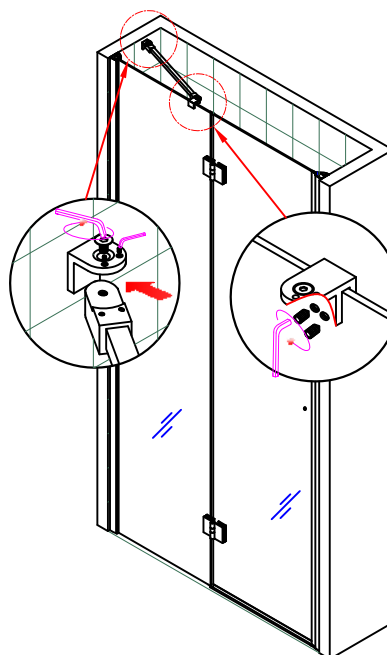

18

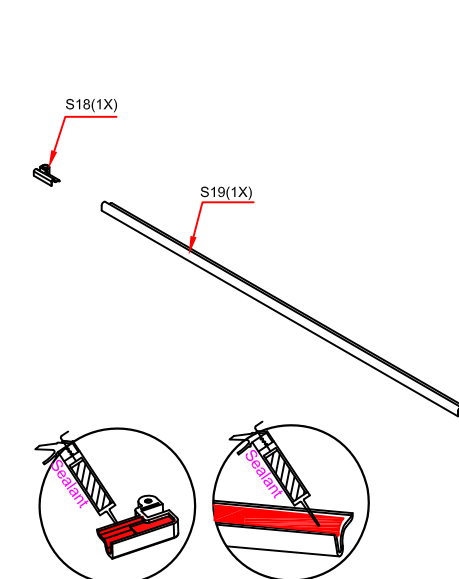

11

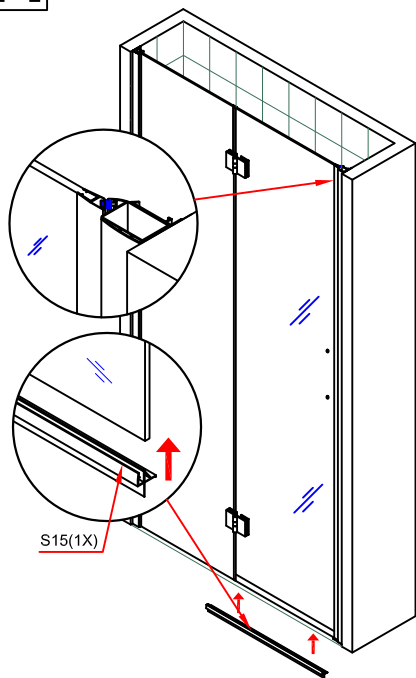

12

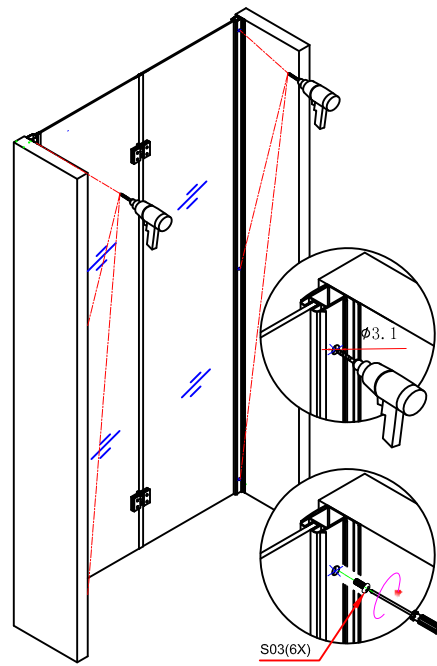

13

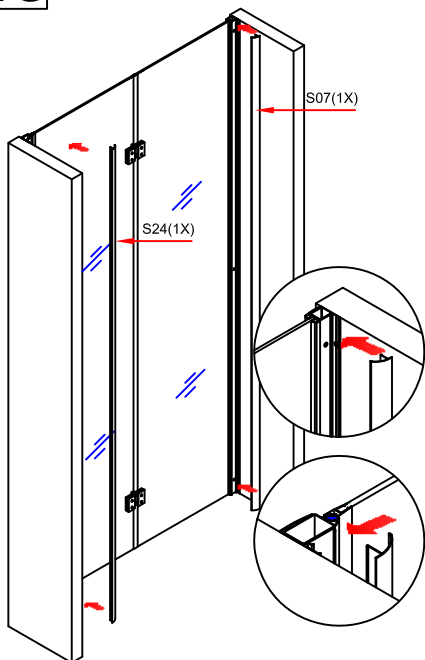

14

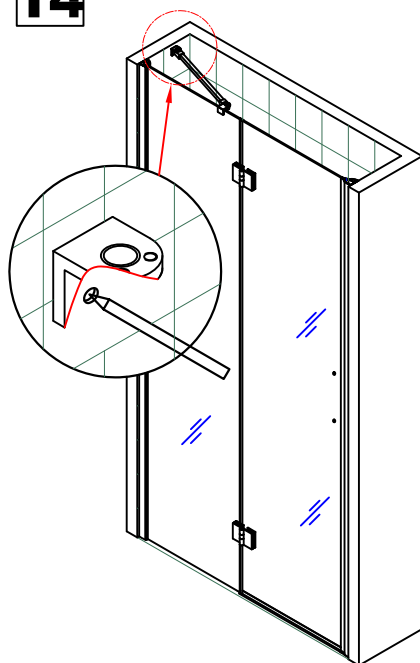

P6

Strumenti per l'installazione

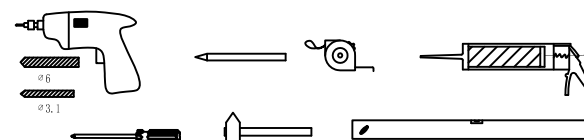

S01



1X

S02



1X

1X

S03

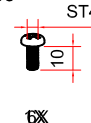

6X

ST4

S04



9X

S05

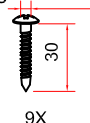

9X

ST4

S09

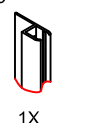

1X

S10

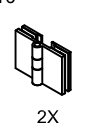

2X

S14

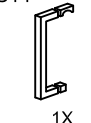

1X

S15

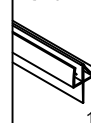

1X

S16



2X

S17

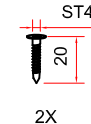

2X

ST4

S18

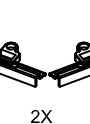

2X

S19



1X

S21

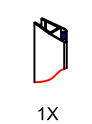

1X

S25



2X

S26



1X

1X

Magnet profile parts (S21-26), which are not included in the package of FANTASY 2, is used in the Niche version assemble.

1

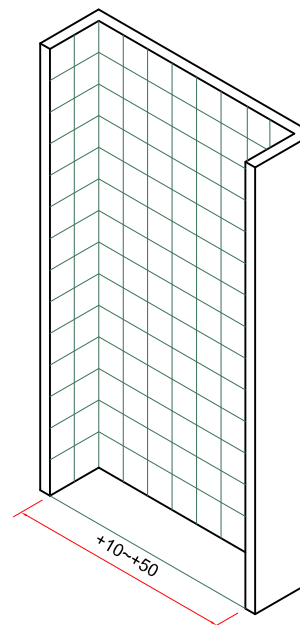

2

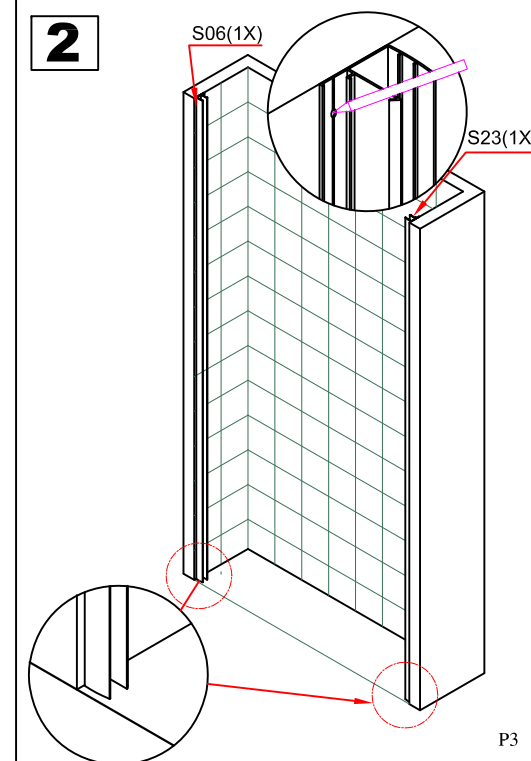

P3

3

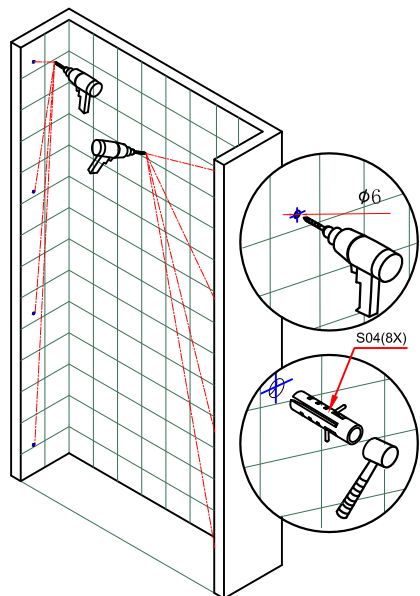

4

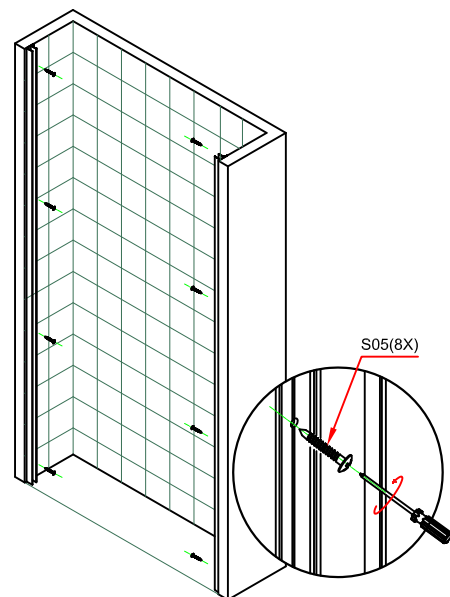

7

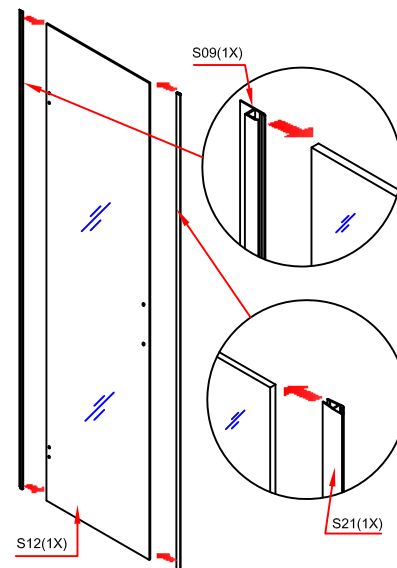

8

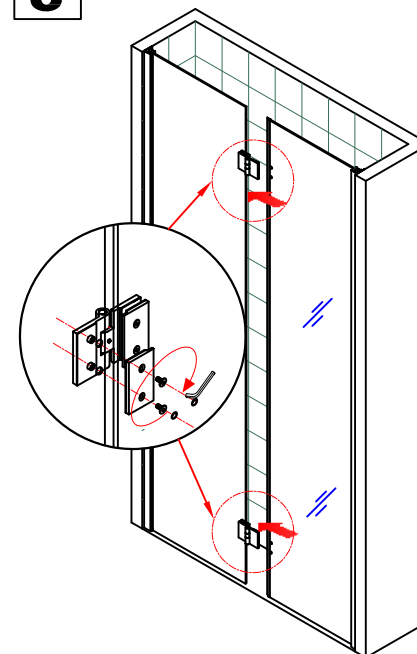

5

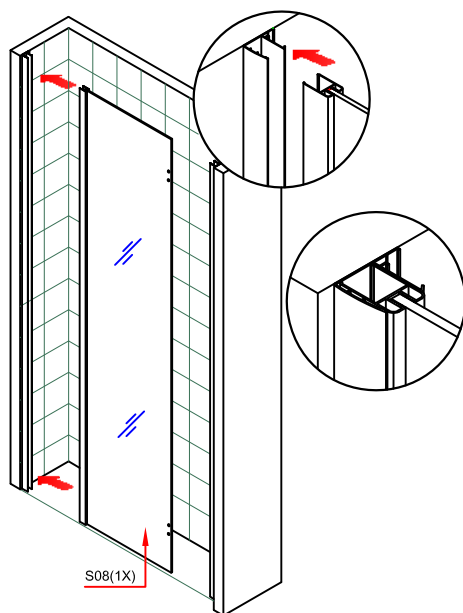

6

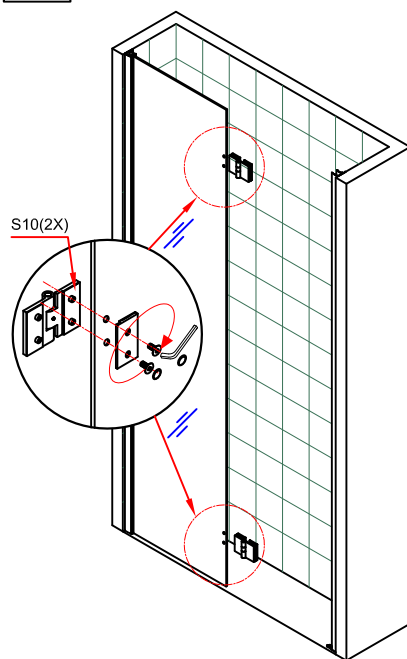

9

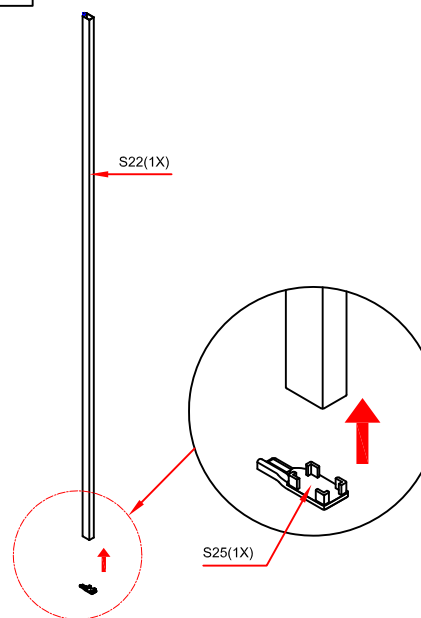

10

